

Better Homes and Gardens Special Interest Publications.

The Storage Issue!

KITCHEN + BATH IDEAS



**32 Ways to
Cut Clutter**

**Cabinet Designs
That Store More** p. 32

**Organize
Your Pantry
This Weekend** p. 52

WINTER 2013
Display until March 10

\$6.99 U.S.

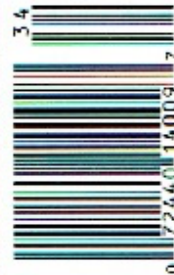

BHG.com/KitchenBath



MATERIAL SELECTION

Colorful finishes turn a blah kitchen into something special.

writer KRISTINA MCGUIRK
photographer JASON DONNELLY
illustrator ANN WEISS

THE PROBLEMS

1. Closed off by a peninsula, the layout lacked a flow conducive to cooking while entertaining.
2. Small windows limited natural light and outdoor views.
3. Although in good condition, the white-on-white kitchen had no personality.
4. The limited countertop space near the main work core felt crowded by overhead cabinetry and appliances opening into the area.

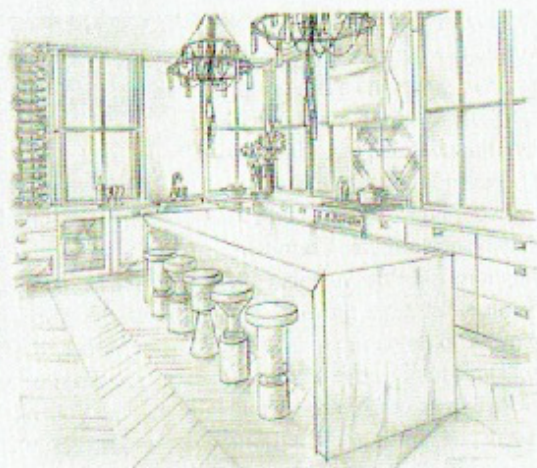



DESIGNER

Located near Boston, Kristina Crestin designs with special attention to architectural details, materials, and color. Visit kristinacrestindesign.com to find out more.

“Allow the kitchen to be more creative and fun—mix vintage and modern in a successful way for a fresh take on your style.”

Kristina Crestin
Designer

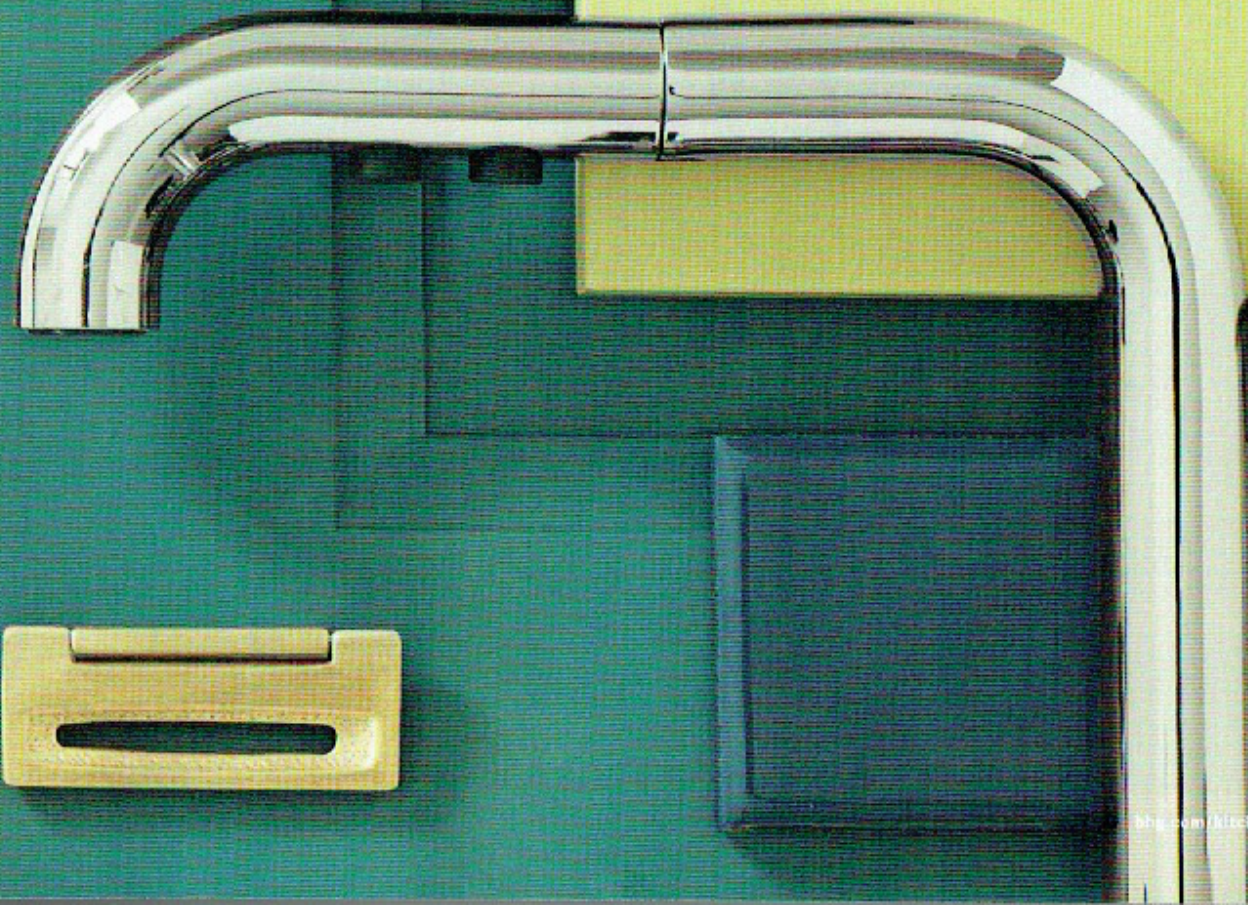

These colorful tiles inspired the palette. It is OK to splurge on the perfect tile because the backsplash area is so small.

Adding 6-inch casters brings a prefab table up to 36 inches tall (standard countertop height)—perfect for an island.

DO-IT-YOURSELF KITCHEN IDEAS

From tiling to decorating, it's easier than you think to put a personal touch on your kitchen. BHG.com/KitchenProjects



FAUCET
Purist single-hole pullout
in polished chrome | \$495
Kohler
us.kohler.com



RANGE
36-inch Nova in
color 6027 | \$5,933
BlueStar
bluestarcooking.com

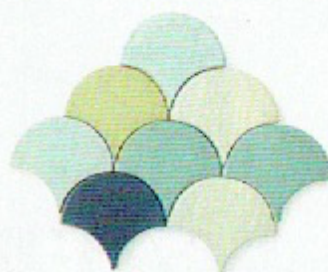

TILE
Shapes collection fan
tile | \$43 per square foot
Tabarka Studio
tabarkastudio.com



HARDWARE
Streamline hook in
Slate | \$16
Anthropologie
anthropologie.com

THE SOLUTIONS

1. Removing the peninsula opens the kitchen to the adjacent dining room, while new windows enhance the view and natural light.

2. The island on wheels provides both a place to sit and a work area as needed. Plus, it can be moved out of the way or into another room to serve as a buffet.

3. Adding custom doors to stock cabinet bases and picking a vibrant color brightens the space. The range and backsplash top off the look.

4. Painting inside the pendant lights, do-it-yourself concrete countertops, salvaged pantry doors (not illustrated), and using hooks as drawer pulls add budget-friendly personal touches.

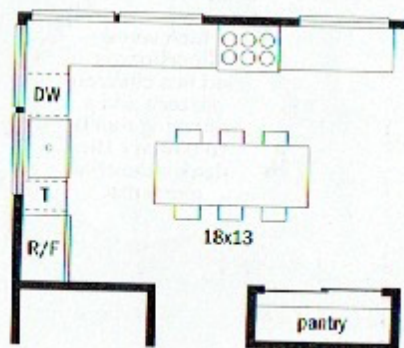

AFTER

VALUE BUDGET

APPLIANCES

BlueStar 36-inch Nova in color 6027	\$5,933
Fisher & Paykel ActiveSmart counter-depth French-door refrigerator	\$2,699
BlueStar 36-inch Pro line hood in color 6027	\$1,200
Bosch 300 DXL integrated dishwasher	\$850

CABINETS

Stock cabinet bases with custom shiplap doors by Premier Builders Inc., painted in Benjamin Moore Grasshopper	\$4,000
---	---------

SURFACES

Hunt Flooring random-width white oak flooring	\$4,000
Tabarka Studio Shapes fan tile backsplash	\$1,500
Concrete countertop materials	\$400

MISCELLANEOUS

Kohler Whitehaven undermount single-bowl sink in Annapolis Navy	\$1,799
Kohler Purist pullout faucet in polished chrome	\$495
Restoration Hardware Circa 1900 Train Station swing-arm sconce	\$179
Shades of Light Oversized Cone Paper Shade pendants in gloss white	\$498
Anthropologie Streamline hook drawer pulls	\$288
Crate & Barrel Big Sur dining table	\$1,799
Mockett hollow-wheel casters for table island	\$192
SugarSCOUT Etsy shop Tolix stools, painted	\$948
Sherwin-Williams Loyal Blue	
Salvaged pantry doors	\$610

TOTAL

prices are estimates, excluding installation

\$27,390

New bypass windows give the kitchen an urban look. Plus, by sliding open sideways, they open the kitchen to the patio.

Rich wood floorboards laid in a chevron pattern add a warming touch to balance the sleek industrial elements.



FAUCET
Henry gooseneck kitchen faucet | \$2,985
Waterworks
waterworks.com



RANGE
Professional 36-inch dual fuel in black | \$5,899
Bertazzoni
bertazzoni.com

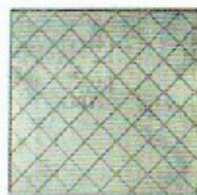

TILE
Versailles Mesh in Silver Flake Rustic | \$114 per square foot
Ann Sacks
annsacks.com



HARDWARE
Ted Boerner tab pendant in silicon bronze light | \$80
Rocky Mountain Hardware
rockymountainhardware.com

THE SOLUTIONS

1. An urban restaurant design gives the kitchen easy ways to entertain while cooking: dedicated beverage areas outside the work core, seating at the island, long expanses of countertop work space, and professional-grade appliances.

2. The bronze sink, dangling light fixtures, and whimsical stools meld with the industrial design and prevent a cold or impersonal vibe.

3. A deep, sophisticated color palette is illuminated by metallic finishes and natural light.

4. An adjacent powder room becomes a new pantry, while the old pantry location now houses the refrigerator and a convenient serving station.

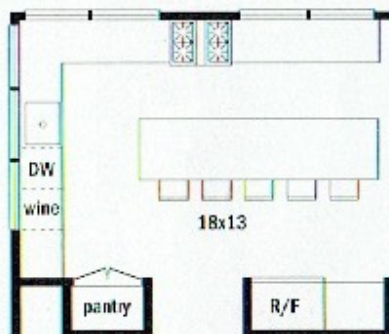

AFTER

CUSTOM BUDGET

APPLIANCES

Custom brass-wrapped vent hood	\$6,700
Liebherr model 2061 integrated refrigerator	\$6,500
Bertazzoni Professional series 36-inch dual-fuel range	\$5,899
U-Line Wine Captain undercounter wine cooler	\$2,439
Bosch 300 DXL integrated dishwasher	\$850

CABINERY

Custom cabinetry designed by Kristina Crestin, painted Sherwin-Williams Deep Sea Dive	\$70,000
---	----------

SURFACES

Marble countertops	\$10,000
Ann Sacks Versailles Mesh backsplash tile in Silver Flake Rustic	\$5,000
Carlisle Wide Plank Floors walnut boards laid in chevron pattern	\$3,700

MISCELLANEOUS

Rocky Mountain Alturas apron-front sink in silicon bronze light	\$8,498
Bespoke Global Anna Karlin brass Chess stools	\$8,475
Arteriors Winston chandeliers in antique brass	\$5,000
Waterworks Henry gooseneck kitchen faucet	\$2,985
Ted Boerner for Rocky Mountain Hardware tab pendant pulls in silicon bronze light	\$1,600

TOTAL

prices are estimates, excluding installation

\$137,646